



## LIFTING POINTS

Quality, Reliability & Innovation



### Super Point

- Pivots to 230°, rotates through 360° due to its unique ball bearing design.
- Manufactured from forged alloy steel, quenched and tempered.
- Tested in accordance with EN1677-4.
- Certified by DGUV GS-OA 15-04.
- Load rated parts are 100% magnaflux crack detected.
- Individual forged parts and batch code links to Test Certificate sheet.
- Bolts are Metric thread.
- Proof tested to 2.5 times the WLL.
- Fatigue rated to 20,000 cycles at 1.5 times the WLL.
- All YOKE Lifting points meet or exceed all the requirements of ASME B30.26.
- Easy to attach or dismantle due to the forged hexagon shaped body of the Super Point
- Capable of rotating under load.
- Do not turn continuously in 90 degree direction at full load.

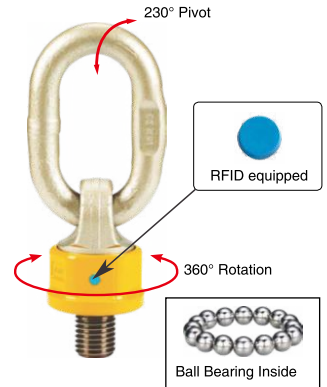

Product Code	WLL		Thread Version			Dimensions							Torque in	N.W.
	Tonnes		M	E	Pitch	A	B	C	D	F	S	SW		
	X	(Z)	mm	mm	DIN13	mm							Nm	Kg
YKLPB10	0.4	(1)	M10	15	1.5	36	25	8	9	25	6	44	10	0.1
YKLPB12	0.75	(2)	M12	18	1.75	45	30	10	11	33	8	52	10	0.2
YKLPB16	1.5	(4)	M16	24	2	52	35	14	13	35	10	61	30	0.3
YKLPB20	2.3	(6)	M20	30	2.5	60	40	16	15	44	12	70	70	0.6
YKLPB24	3.2	(8)	M24	36	3	72	48	19	18	52	14	84	150	1.0
YKLPB30	4.5	(12)	M30	45	3.5	90	60	24	22	60	17	105	350	1.8
YKLPB36	7.0	(16)	M36	54	4	109	72	29	27	76	22	126	410	3.2
YKLPB42	9.0	(24)	M42	63	4.5	123	82	34	32	88	24	147	550	5.0
YKLPB48	12.0	(32)	M48	72	5	144	94	38	37	104	27	168	550	7.6
YKLPB56	12.0	(32)	M56	84	5.5	147	102	40	43	124	27	178	800	9.2

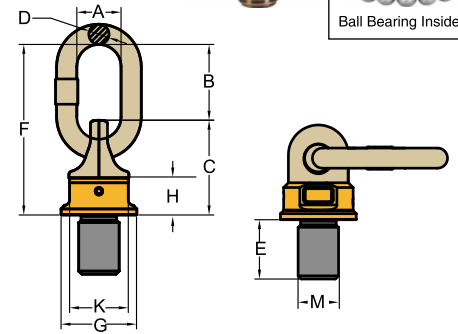

### Key Eye Point

- Rotates through 360° adjustable in the direction of the load.
- Manufactured from alloy steel, quenched and tempered.
- Tested in accordance with EN1677-1.
- Load rated parts are 100% magnaflux crack detected.
- Individual forged parts and cap screw are traceable to Test Certification.
- Bolts are Metric thread.
- Proof tested to 2.5 times the WLL.
- Fatigue rated to 20,000 cycles at 1.5 times the WLL.
- All YOKE Lifting points meet or exceed all the requirements of ASME B30.26.
- Quick and simple assembly, just a tapped hole

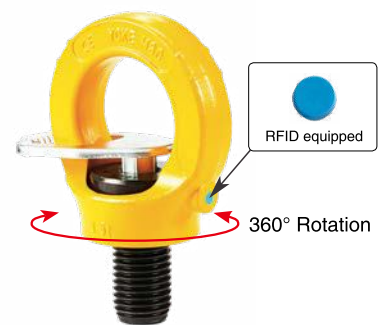

Product Code	WLL	Thread Version			Dimensions								Torque in	N.W.
		M	E	Pitch	A	B	C	D	F	G	S	W		
		mm	mm	DIN13	mm								Nm	Kg
YKLPK08	0.3	M8	12	1.25	36	25	8	9	25	24	6	44	10	0.1
YKLPK10	0.4	M10	15	1.5	36	25	8	9	25	24	6	44	10	0.1
YKLPK12	0.75	M12	18	1.75	45	30	10	11	33	29	8	52	10	0.2
YKLPK16	1.5	M16	24	2	52	35	14	13	35	33	10	61	30	0.3
YKLPK20	2.3	M20	30	2.5	60	40	16	15	44	37	12	70	70	0.6
YKLPK24	3.2	M24	36	3	72	48	19	18	52	46	14	84	150	1.0
YKLPK30	4.5	M30	45	3.5	90	60	24	22	60	58	17	105	350	1.8

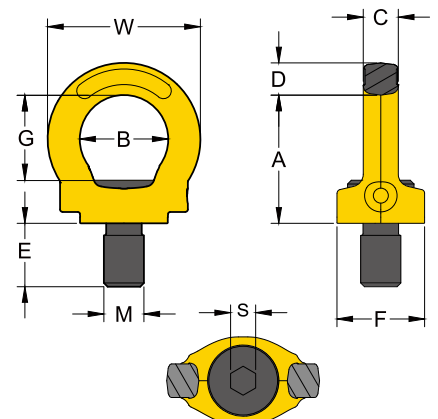



## LIFTING POINTS

Quality, Reliability & Innovation



### Lifting Point

- Rotates through 360° and pivot 90°.
- Manufactured from alloy steel, quenched and tempered.
- Tested in accordance with EN1677-1.
- Certified by DGVV GS-OA 15-04.
- Load rated parts are 100% magnaflux crack detected.
- Individual forged parts and cap screw are traceable to Test Certification.
- Bolts are Metric thread.
- Proof tested to 2.5 times the WLL.
- Fatigue rated to 20,000 cycles at 1.5 times the WLL.
- All YOKE Lifting points meet or exceed all the requirements of ASME B30.26.
- Quick and simple assembly, just a tapped hole is required.

Product Code	WLL	Thread Version			Dimensions									Torque in	N.W.
		M	E	Pitch	A	B	C	D	F	G	H	S	SW		
	Tonnes	mm	mm	DIN13	mm										
YKLPS08	0.3	M8	11	1.25	30	35	35	10	85	55	29	6	13	30	0.2
YKLPS10	0.63	M10	16	1.5	30	35	36	10	85	55	29	6	17	60	0.3
YKLPS12	1	M12	18	1.75	33	37	44	14	98	57	36	8	19	100	0.5
YKLPS14	1.2	M14	21	2	33	37	45	14	98	57	36	10	22	120	0.5
YKLPS16	1.5	M16	24	2	33	37	46	14	98	57	36	10	24	150	0.5
YKLPS18	2	M18	26	2	50	54	57	17	140	82	44	12	30	200	1.3
YKLPS20	2.5	M20	30	2.5	50	54	57	17	140	82	44	12	30	250	1.3
YKLPS24	4	M24	36	3	50	54	59	17	140	82	44	14	36	400	1.4
YKLPS27	4	M27	38	3	60	65	79	23	170	99	62	17	41	400	2.8
YKLPS30	5	M30	48	3.5	60	65	81	23	170	99	62	17	46	500	3.1
YKLPS36	7	M36	54	4	60	65	88	178	23	178	99	22	55	700	3.3
YKLPS42	10	M42	72	4.5	77	85	104	27	225	124	78	24	65	1000	6.3
YKLPS48	20	M48	72	5	95	104	120	36	259	158	90	27	75	2000	11.6

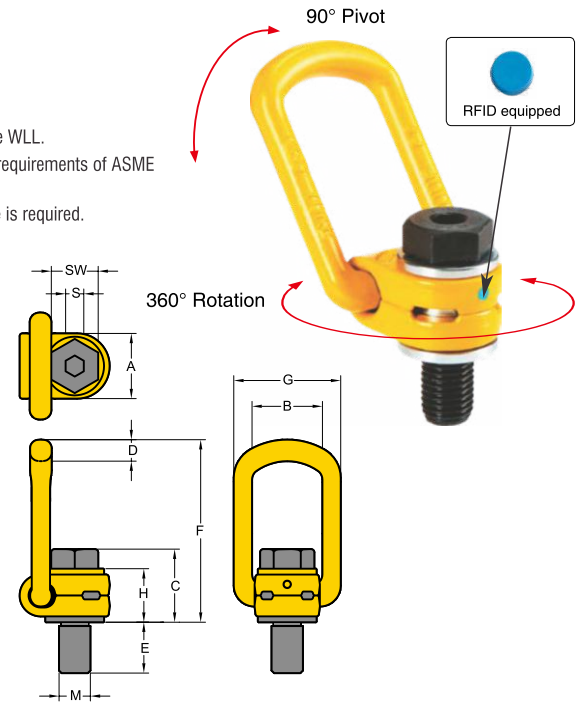

### Lifting Point Extended Bolt

- Rotates through 360° and pivots 90°.
- Manufactured from alloy steel, quenched and tempered.
- Tested in accordance with EN1677-1.
- Load rated parts are 100% magnaflux crack detected.
- Individual forged parts and cap screw are traceable to Test Certification.
- Bolts are Metric thread.
- Proof tested to 2.5 times the WLL.
- Fatigue rated to 20,000 cycles at 1.5 times the WLL.
- All YOKE Lifting points meet or exceed all the requirements of ASME B30.26.
- Quick and simple assembly, just a tapped hole is required.

Product Code	WLL	Thread Version			Dimensions									Torque in	N.W.
		M	E	Pitch	A	B	C	D	F	G	H	S	SW		
	Tonnes	mm	mm	DIN13	mm										
YKLPSXB16-149	1.5	M16	149	2	33	37	46	14	98	57	36	10	24	150	0.7
YKLPSXB20-186	2.5	M20	186	3	50	54	57	17	140	82	44	12	30	250	1.7
YKLPSXB24-221	4.0	M24	221	3	50	54	59	17	140	82	44	14	36	400	2.1

